

# GC - Series

Compact Metal Body

Position & Limit Switches



# Position & Limit Switches

## GC Series - Metal Body



### Product characteristics

- Protection class IP65 conforming to VDE 0470 T1
- Enclosure: Die-cast aluminium
- Cover: Sheet aluminium
- Actuator can be repositioned by 4 x 90°
- Cable entry M20 x 1.5
- Connection designation conforming to DIN EN 50013
- Metal actuators for high loads
- Graduated adjustment of the AH lever
- Selectable direction-dependent contact-making of the AH actuator (basic setting: contact-making on both sides)

### Good to know ...

Thanks to its compact design, this metal-enclosed switch is ideally suited for virtually all safety and position monitoring applications.

### Options

- Customised cables and connectors available on request

# Position & Limit Switches

## GC Series - Metal Body

### Technical data

Electrical data		
Design insulation voltage (up to) <sup>①</sup>	U <sub>i</sub> max.	400 V AC
Conventional thermoelectric current (up to) <sup>①</sup>	I <sub>the</sub>	10 A
Rated operating voltage	U <sub>e</sub> max.	240 V
Utilisation category (up to) <sup>①</sup>		AC-15, U <sub>e</sub> /I <sub>e</sub> 240 V/3 A
Short circuit protection (up to) <sup>①</sup>		Safety fuse 10 A gL/gG
Protection class		I
Mechanical data		
Enclosure material		Die-cast aluminium
Ambient temperature		-30 °C to + 80 °C
Mechanical lifetime (up to) <sup>①</sup>		10 x 10 <sup>6</sup> switching cycles
B10d (up to) <sup>①</sup>		20 million
Switching frequency		≤ 100/min.
Type of connection		Screwed connections
Conductor cross-sections		Single-wire 0.5 – 1.5 mm <sup>2</sup> or strand with wire-end ferrule 0.5 – 1.5 mm <sup>2</sup>
Cable entry		1 x M20 x 1.5
Protection class		IP65 conforming to IEC/EN 60529
Standards		
VDE 0660 T100, DIN EN 60947-1, IEC 60947-1		
VDE 0660 T200, DIN EN 60947-5-1, IEC 60947-5-1		

<sup>①</sup> Depending on switching system

### Technical design

- Slow- and snap action
- **Versions:** 1 NC/1 NO, 2 NC/2 NO, 2 NC, overlapping contacts
- All NC contacts with ⊕ in the circuit diagram are positively opening contacts
- Type: Zb (galvanically isolated changeover contact)
- Latching function available on request

### Mounting

- 2 M4 oval holes for adjustment  
(for safety applications there is a blind hole for a Ø 4.0 mm fitted pin in the enclosure base or an enclosure with holes for M5)



# Position & Limit Switches

## GC Series - Metal Body

### GC-... IW

Replacement actuator: 3912030546

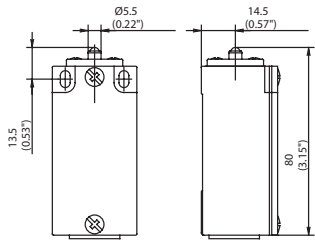

	1 NC / 1 NO	2 NC
--	-------------	------

Slow-action system

**6021102001**  
GC-U1Z IW

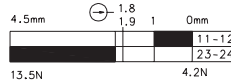

**6021802189**  
GC-A2Z IW

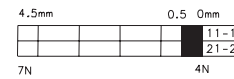

Snap-action system

**6021102001**  
GC-U1Z IW



Special features: on request

### GC-... STIW

Replacement actuator: 391205023

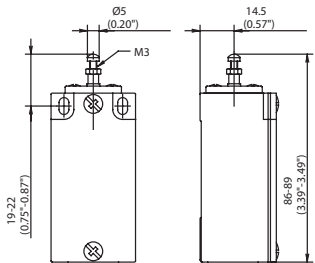

	1 NC / 1 NO	1 NC / 1 NO overlapping
--	-------------	-------------------------

Slow-action system

**602 1105015**  
GC-U1Z STIW

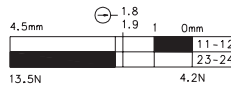

**6021305016**  
GC-UV1Z STIW

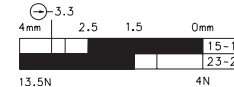

Snap-action system

**6021155017**  
GC-SU1Z STIW



Special feature: Actuator length adjustable with adjusting screw

# Position & Limit Switches

## GC Series - Metal Body



Replacement actuator: 3912170518

GC-... RIW

	1 NC / 1 NO	2 NC	1 NC / 1 NO overlapping
--	-------------	------	-------------------------

Slow-action system

**6021117029**  
GC-U1Z RIW

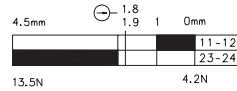

**6021817172**  
GC-A2Z RIW

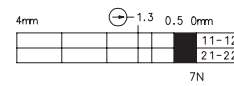

**6021317030**  
GC-UV1Z RIW

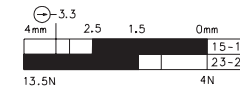

Snap-action system

**6021367626**  
GC-SU1Z RIW

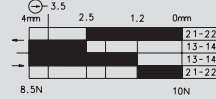

Special features (on request): available for high temperature range and the following contacts: 2 NC / 1 NO; 2 NC / 2 NO (larger enclosure)

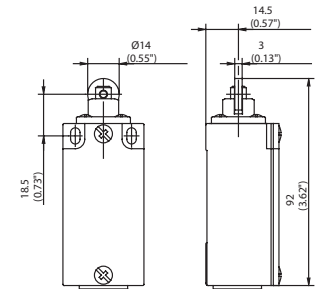

Replacement actuator: 3912350722

GC-... AH

	1 NC / 1 NO	2 NC	2 NO	1 NC / 1 NO overlapping
--	-------------	------	------	-------------------------

Slow-action system

**6021135102**  
GC-U1Z AH

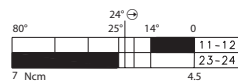

**6121835833** siehe gesondertes  
GC-A2Z AHS Datenblatt

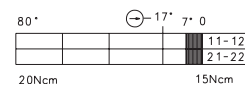

**6021835160**  
GC-E2 AH

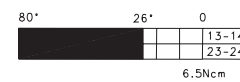

**6021335133**  
GC-UV1Z AH

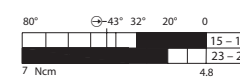

Snap-action system

**6021385634**  
GC-SU1Z AH



Special feature (on request): available with various roller diameters, cranked or straight lever and with various lever lengths with roller over switch and with the following contacts: 2 NC / 2 NO (larger enclosure)

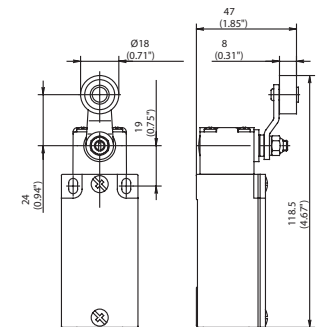

# Position & Limit Switches

## GC Series - Metal Body

### GC-... AV

Replacement actuator: 3912360723



1 NC / 1 NO

Slow-action system

**6021136104**  
GC-U1 AV

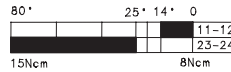

Snap-action system

**6021186118**  
GC-SU1 AV

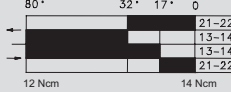

Special features (on request): various roller diameters; different lever lengths; with roller over switch and with the following contacts: 2 NC / 2 NO

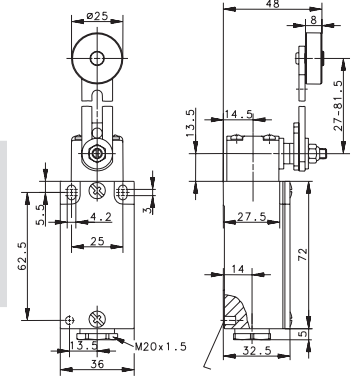

### GC-... AD

Replacement actuator: 3912370724



1 NC / 1 NO

Slow-action system

**6021137103**  
GC-U1 AD

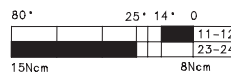

Snap-action system

**6021187125**  
GC-SU1 AD

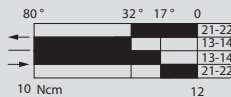

Special features (on request): available with various actuator lengths and actuator directions; with the following contacts: 2 NC / 1 NO with overlap (larger enclosure)

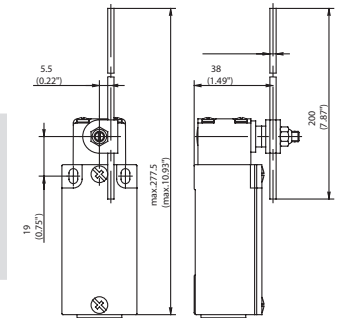

# Position & Limit Switches

## GC Series - Metal Body



Replacement actuator: 3912200552

**GC... HIW**

	1 NC / 1 NO	2 NC	2 NO	1 NC / 1 NO overlapping
<b>Slow-action system</b>	<b>6021120057</b> GC-U1Z HIW 	<b>6021820175</b> GC-A2Z HIW 	<b>6021820157</b> GC-E2 HIW 	<b>6021320058</b> GC-UV1Z HIW 
<b>Snap-action system</b>	<b>6021370629</b> GC-SU1Z HIW 			

**Special features** (on request): available with different actuating directions; available with a steel roller; with the following contacts: 2 NC / 2 NO; 1 NC / 2 NO with overlap (larger enclosure)

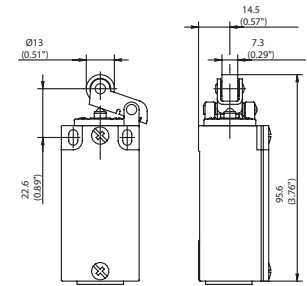

Replacement actuator: 3912400510

**GC... FF**

	1 NC / 1 NO
<b>Slow-action system</b>	<b>6021140476</b> GC-U1 FF 
<b>Snap-action system</b>	<b>6021190100</b> GC-SU1 FF 

**Special features** (on request): different spring lengths; different spring versions or spring rod

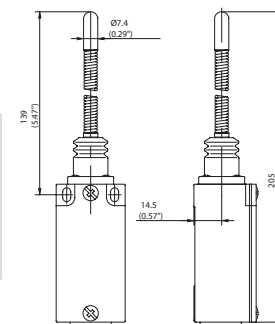

# Position & Limit Switches

## GC Series - Metal Body



### GC-... AF

Replacement actuator: 3912390725



**1 NC / 1 NO**

Slow-action system

**6021139106**  
GC-U1 AF

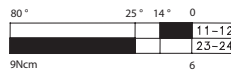

Snap-action system

**6021189128**  
GC-SU1 AF

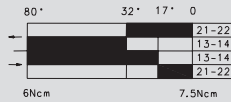

Special features (on request): available with various actuator lengths and actuator directions

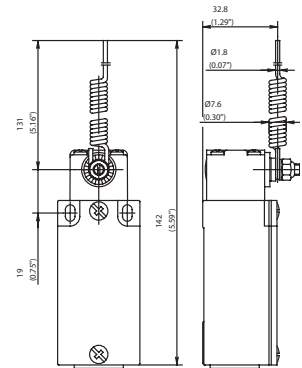

### GC-... DR

Replacement actuator: 3912410593



**1 NC / 1 NO**

Snap-action system

**6021191099**  
GC-SU1Z DR

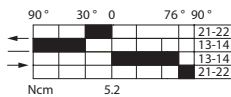

Special features (on request)

