

REVISIONS FOR DWG # FT2218

REV	CH.NO.	DESCRIPTION	DATE	REVISED BY
-	-	ORIGINAL DESIGN	06/10/16	ARON G

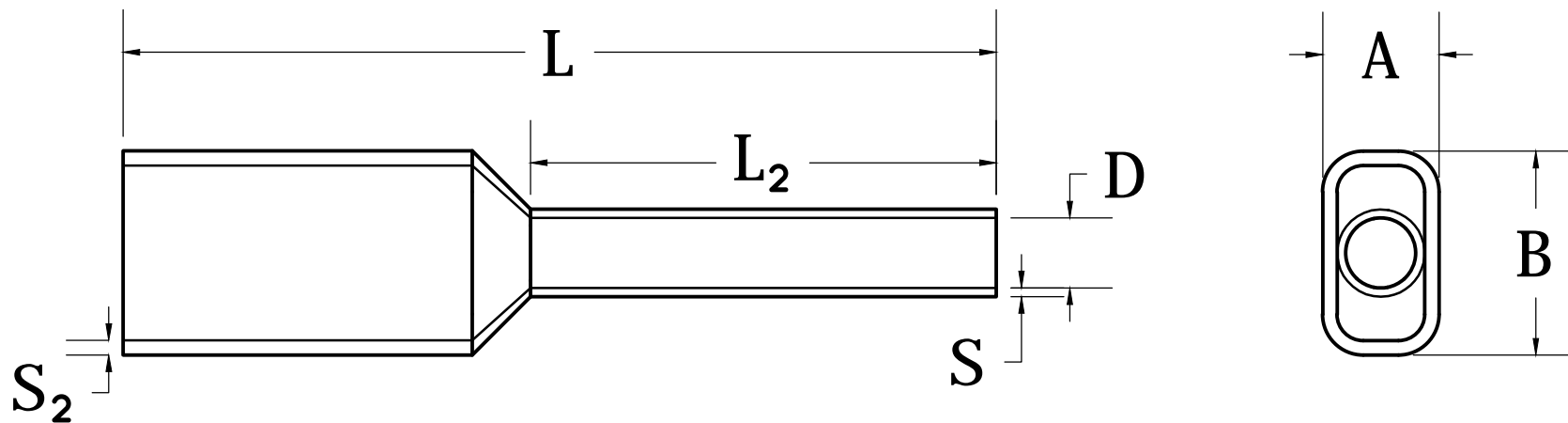

AWG	mm ²	Barrel Length	Industry Standard	DIN Standard		L	L ₂	D	S	S ₂	A	B
2 x 22	2 x 0.34	8	FTI2208	-		15	8	1.2000	0.1500	0.2500	3.5000	2
2 x 20	2 x 0.5	8	FTI2008	FTD2008	2794.0	14	8	1.4000	0.1500	0.3000	5	3
2 x 20	2 x 0.5	10	FTI2010	FTD2010		16	10	1.4000	0.1500	0.3000	5	3
2 x 20	2 x 0.5	12	FTI2012	FTD2012		18	12	1.4000	0.1500	0.3000	5	3
2 x 18	2 x 0.75	8	FTI1808W	FTD1808GR	2775.0	14	8	1.7000	0.1500	0.3000	5.5000	3
2 x 18	2 x 0.75	10	FTI1810	FTD1810	2795.0	16	10	1.7000	0.1500	0.3000	5.5000	3
2 x 18	2 x 0.75	12	FTI1812W	FTD1812GR		18	12	1.7000	0.1500	0.3000	5.5000	3
2 x 18	2 x 0.75	18	FTI1818W	FTD1818GR		24	18	1.7000	0.1500	0.3000	5.5000	3
2 x 18	2 x 1	8	FTI1808Y	FTD1808R	2776.0	15	8	2	0.1500	0.3000	5.8000	3.2000
2 x 18	2 x 1	12	FTI1812Y	FTD1812R		19	12	2	0.1500	0.3000	5.8000	3.2000
2 x 18	2 x 1	14	FTI1814Y	FTD1814		21	14	2	0.1500	0.3000	5.8000	3.2000
2 x 18	2 x 1	18	FTI1818Y	FTD1818R	2796.0	25	18	2	0.1500	0.3000	5.8000	3.2000

UNLESS OTHERWISE SPECIFIED
 • ALL DIMENSIONS ARE IN MILLIMETERS
 • THIRD ANGLE PROJECTION

• TOLERANCE	
XX	± 1.00 mm
XX.X	± 0.50 mm
XX.XX	± 0.20 mm
ALL	± XX mm

CIRTIM

This Drawing is the property of

Altrech Corp.

35 Royal Road
 Flemington NJ 08822-6000
 (908) 806-9400 • Fax (908) 806-9490

AND IS A CONFIDENTIAL DISCLOSURE
 LENT WITHOUT CONSIDERATION OTHER
 THAN THE BORROWER'S AGREEMENT
 THAT IT SHALL NOT BE REPRODUCED,
 COPIED, LENT, OR DISPOSED OF
 DIRECTLY OR INDIRECTLY NOR USED
 FOR ANY PURPOSE OTHER THAN THAT
 FOR WHICH IT IS SPECIFICALLY
 FURNISHED.

TITLE: Twin Insulated Wire Ferrules
 2x22AWG to 2x18AWG

DRAWN BY: Aron Gyorgypal	06/08/16
CHECKED BY: Morgan E	06/08/16
RELEASED BY: Laszlo G	06/10/16

DRAWING NO.:	REV.:
M-Cad-6FU-FT2218	-
SCALE: -	SHEET: 1 OF: 1