

REVISIONS FOR DWG # 2PLLXL

REV	CH.NO.	DESCRIPTION	DATE	REVISED BY
-	-	ORIGINAL DESIGN	07/20/16	ARON G

M28x1

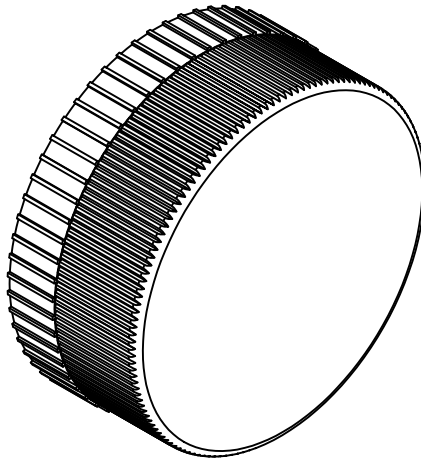
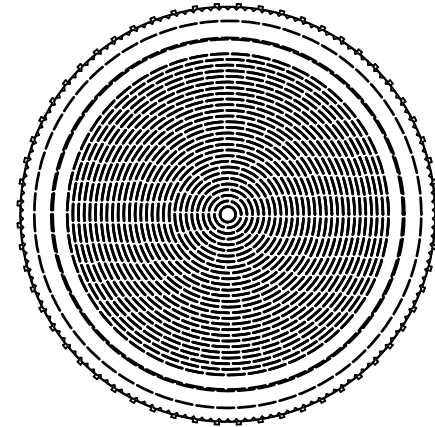
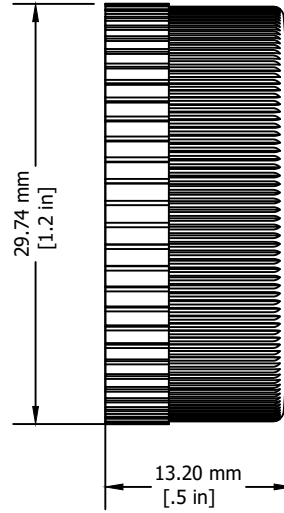
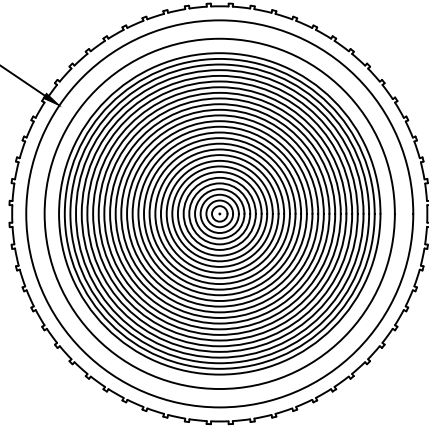

Color	Cat. No.
White	2PLL1L
Green	2PLL3L
Red	2PLL4L
Amber	2PLL5L
Blue	2PLL6L
Clear	2PLL7L
Yellow	2PLL8L

UNLESS OTHERWISE SPECIFIED
 • ALL DIMENSIONS ARE IN MILLIMETERS
 • THIRD ANGLE PROJECTION

TOLERANCE	
XX	± 1.00mm
XX.X	± 0.50 mm
XX.XX	± 0.20 mm
ALL	± .XXmm

C-RTM

This Drawing is the property of

Altrech Corp.

35 Royal Road
 Flemington NJ 08822-6000
 (908) 806-9400 • Fax (908) 806-9490

AND IS A CONFIDENTIAL DISCLOSURE
 LENT WITHOUT CONSIDERATION OTHER
 THAN THE BORROWER'S AGREEMENT
 THAT IT SHALL NOT BE REPRODUCED,
 COPIED, LENT, OR DISPOSED OF
 DIRECTLY OR INDIRECTLY NOR USED
 FOR ANY PURPOSE OTHER THAN THAT
 FOR WHICH IT IS SPECIFICALLY
 FURNISHED.

TITLE: 22mm Push Button Accessory
 Lenses for Pilot Lights with LED

DRAWN BY: Aron Gyorgypal	07/20/16	DRAWING NO.:	M-Cad-1PB-2PLLXL	REV.:	-
CHECKED BY: Laszlo G	07/20/16	SCALE:	-	SHEET:	1 OF: 1
RELEASED BY: Laszlo G	07/20/16				